

Eden Prairie



16500-16550 W. 78th Street,
Eden Prairie, MN 55346



86,536 SF



Kris Schisel
p: 612-359-1691
e: kris.schisel@transwestern.com



Property Summary GLA: 86,536

Highlights

Eden Prairie is the preeminent neighborhood shopping destination for one of the most affluent suburbs of Minneapolis. The property is located on the highly trafficked corner of Highway 5 and Eden Prairie Road with easy access via a signalized intersection and a large parking field. Anchored by a top-specialty grocery store, Kowalski's, and nestled among high income residents, the center affords an unparalleled opportunity for success.



Trade Area

	1 Mile	3 Mile	5 Mile
Population	5,104	60,185	135,112
No. of Households	2,130	23,382	54,482
Avg. HH Income	\$158,881	\$161,702	\$156,534

Where It Really Matters.



Eden Prairie



16500-16550 W. 78th Street, Eden Prairie, MN 55346



Kris Schisel
p: 612-359-1691
e: kris.schisel@transwestern.com

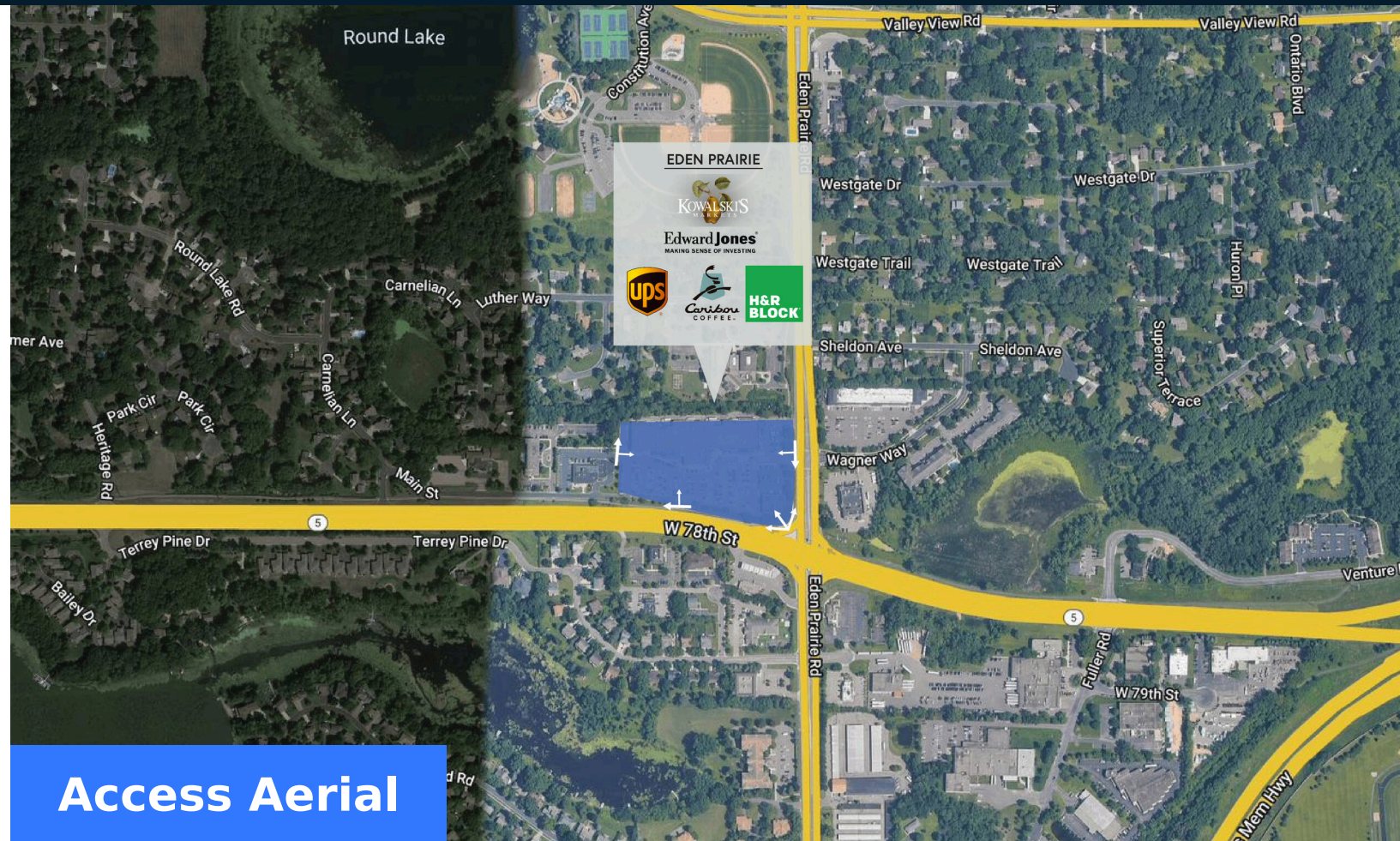

Where It Really Matters.



Eden Prairie



Kris Schisel
 p: 612-359-1691
 e: kris.schisel@transwestern.com

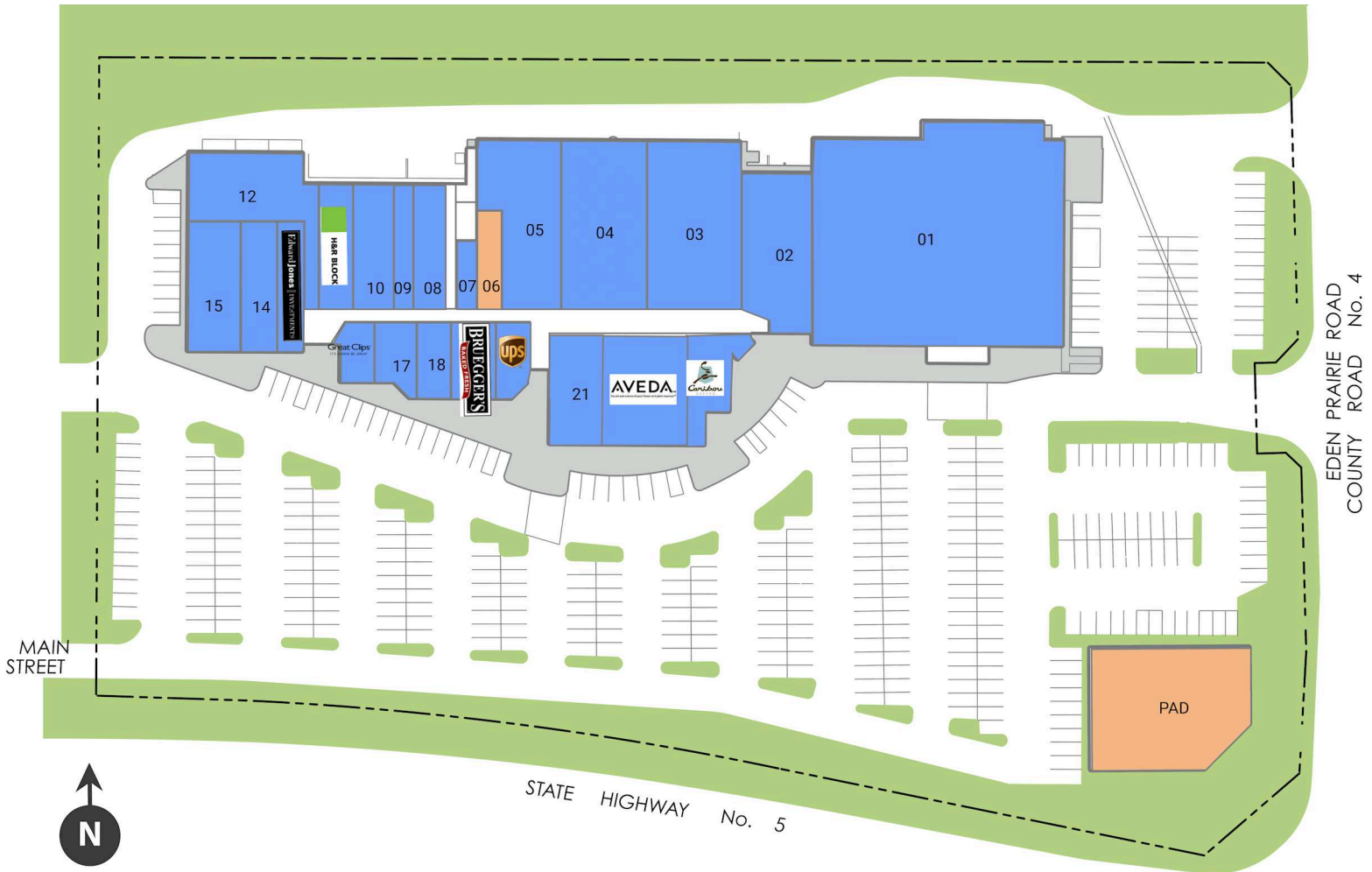

■ AVAILABLE SPACE

Retailers	SF
PAD Available	7,600
01 Kowalski's	23,489
02 Patina	5,250
03 Eden Prairie Liquor	8,001
04 Inside Edge Golf	6,276
05 Parkway Dental	3,390
06 Available	900
07 Lisa's Tailor Shop	475

Retailers	SF
08 LeVici	1,775
09 Perfect Nails	1,076
10 Way Cool Cooking School	2,051
11 H&R Block	1,260
12 OSR Physical Therapy	5,140
13 Edward Jones	1,000
14 Jes Naturals	1,600
15 Family Eye Clonic	2,750

Retailers	SF
16 Great Clips	921
17 Nautical Bowls	1,275
18 Freeziac Frozen Yogurt	1,045
19 Bruegger's Bagels	1,450
20 The UPS Store	1,150
21 Bombay Pizza	2,842
22 Aveda	4,150
23 Caribou Coffee	1,670

GLA TOTAL 86,536

Where It Really Matters.

